

Pos. Nr. Pos.no.	Beschreibung Description	Art.-Nr. Art.no.	Preisgruppe Price bracket
7560023 DB-AG Br 151 =			
N			
7570023 =			
N			
1	GEHÄUSE O.P. BETR. NR. 151 077-5 Body ass. w/o panto. 151 077-5	107560023	38
2	TS-LICHTLEITER Part set-Light conductor	13738004	9
3	TS-ISOLATOREN Part set-Isolators	14737801	12
4	TRAVERSE Roof traverse	177560023	4
5	PRESSLUFTSCHALTER Air pressure switch	18733803	4
6	ISOLATOR+SCHALTFEDER Isolator+spring	64734602	8
7	ANTENNE Antenna	00197807	2
8	ROHR Brass tube	00567770	2
9	LICHTPLATINE KPL. Light PCB,complete	65716500	14
10	SCHALTPLATINE kpl. Switch plate complete	65716600	28
11	BRÜCKENSTECKER Jumper	00664005	13
12	STROMABNEHMER Pantograph	67705500	18
13	SCHRAUBE Screw	00700303	1
14	SENKSCHRAUBE Countersunk screw	00702303	1
15	PUFFER Buffer	757560023	3
16	LICHTLEITER Light conductor	137560023	4
Sound			
17	LAUTSPRECHER Loudspeaker	68701100	16
18	LAUTSPRECHERAUFNAHME Loudspeaker reception	68701300	16
19	SOUNDDECODER Sound decoder	68738072	41

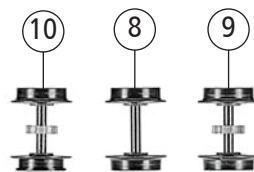
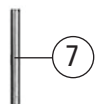
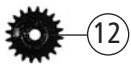
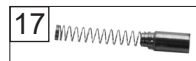
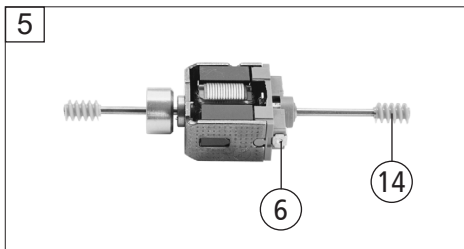
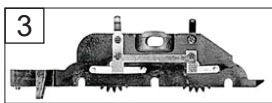
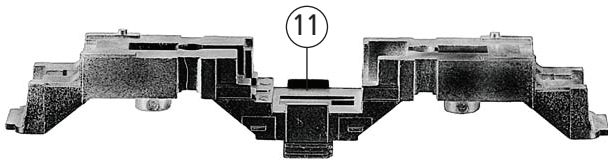

Pos. Nr. Pos.no.	Beschreibung Description	Art.-Nr. Art.no.	Preisgruppe Price bracket
1	HAFTREIFEN Traction tyre	00547002	1
2	DREHGESTELLRAHMEN Bogie framework	41738010	11
3	DREHGESTELLBLOCK KPL. Bogie block, complete	457560023	16
4	ACHSE D=1,5 L=5,7 mm Axle	144459	4
5	MOT.M.SCHW.O.MASSEKONTAKT Motor with flywheel w/o ground cont.	05073821	30
6	KOHLENHALTER Brush holder	00507801	1
7	ACHSE Z.DG-BEFESTIGUNG Bogie fixation pin	00527002	2
8	RADSATZ KPL. OHNE ZAHNRAD Wheelset complete, w/o gear wheel	00537038	12
9	RADSATZ KPL. MIT ZAHNRAD Wheelset complete, with gear wheel	00537039	13
10	RADSATZ KPL.(M.ZAHNRAD) Wheelset complete (with gear wheel)	00537049	13
11	GRUNDRAHMEN Base frame	40738002	19
12	ZAHNRAD Z=20 Gear wheel	00567101	3
13	ZAHNRAD Z=24 Gear wheel	00567131	2
14	SCHNECKE D = 4MM L = 7MM Worm gear	00567605	6
15	KONTAKTBUEGEL F.DREHGEST. Contact plate for bogie	00657004	13
16	BLATTRICHTFEDER F.KUPPLUNG Flat straightening spring for coupling	00767006	1
17	KOHLEBÜRSTE+FEDER Carbon brush +spring	133936	6
18	KUPPLUNGSHAKEN Coupling hook	146925	3